

# HYDRAULIC TANK LIFT WITH SIDE OUTLET(S)

## EC-SIDE 1 & EC-SIDE 2

### USE

Hydraulic bowl lift automatically transfers kneaded dough to the hopper of a volumetric divider or to a proofing table. Suitable for 80/120/160/200/280 trolley bowls.

### FEATURES

- Discharge on one side (EC-Side 1 model) or on both sides (EC-Side 2 model)
- Robust painted steel construction
- 2 discharge heights available:
  - On the table at 1400 mm (**EC-B model**)
  - In the hopper at an adjustable height from 1400 mm to 1900 mm max (**model EC-H**)
- Designed for semi-industrial use: 2 shifts per day
- Front safety bar in stainless steel

### OPTIONS

- Intermediate discharge heights available on request



### DIMENSIONS

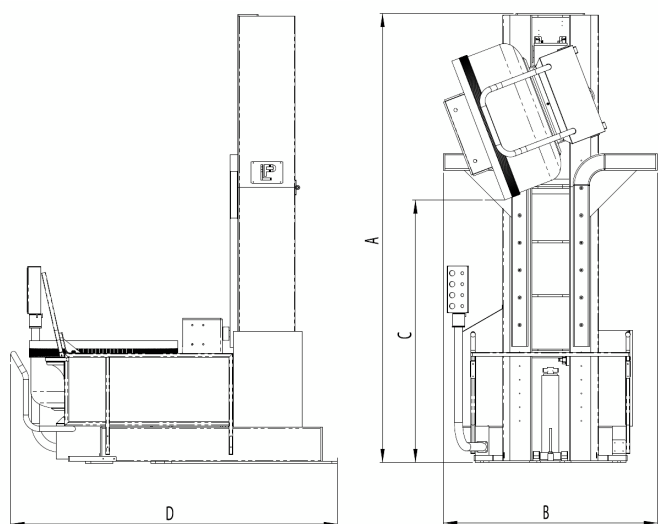

	EC-B	EC-H
	(mm)	
<b>A</b> Max. height under ceiling	2765	3280
<b>B</b> Max. width	1560	1560
<b>C</b> Unloading height	1400	1900
<b>D</b> Max. length	2400	2400

### ELECTRICAL CHARACTERISTICS

Power: 1.5 kW  
Current at 400V/50Hz: 3.8 A  
Current at 220V/60Hz: 7.22 A

### SECURITY

The lift complies with:

- Machinery Directive 2006/42/EC
- The Labour Code

Z.I. de la Turbanière  
BRECE • 35530 • FRANCE

+33 (0)2 99 04 15 30 - salesdpt@merand.fr - www.merand.fr